

TESLA

Elevator Catalog

2025



MADE IN THE
USA



About Tesla Elevator

Tesla Elevator System Technology (branded as the Tesla Elevator, its former legal name Tesla EST.LLC) is an American company that develops, manufactures and markets elevators, escalators, moving walkways, and related equipments. We are one of the well-known manufacturers and suppliers of Elevators. We are 23 years experience in elevator field. We have supplied bed lifts, goods lifts, capsule lifts and passenger lifts at various places.



Tesla Elevator System Technology buildup a big factory in china. We are marketing & sales world wide more then 80 countries. We satisfy the client's requirements through accurate, effective, flexible, rational, and systematic control. It is widely applicable to residences, office buildings, hotel, traffic hub, shopping center, public buildings etc.

TESLA ELEVATOR



MOVING SOLUTIONS WITH SAFETY

CONCENTRATE INTELLIGENCE GUIDE INNOVATION





Optical fiber laser cutting machine production line



Car wall automated assembly line



CNC bending machine



Italy imported SALVANINI flexible sheet metal processing production line



Escalator production workshop



Spraying Line (German WAGNER Spraying Room)

Walk into Tesla Elevator

Strong Strength, fulfilling mission
Advanced USA manufacturing technology,
Casting cutting -edge quality



HIGH SPEED ELEVATOR

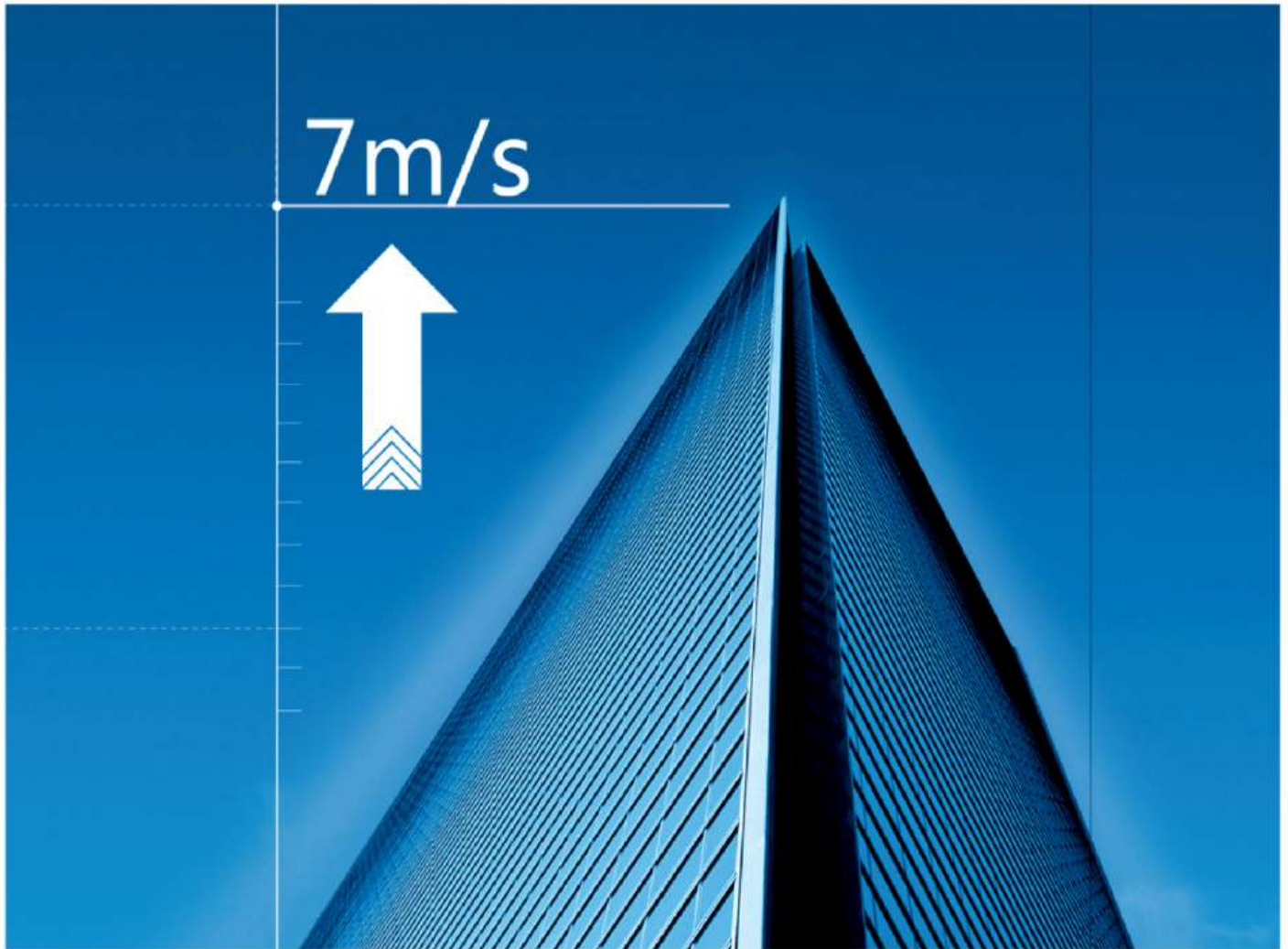

▼ The Extremely Comfortable Travel

A shock-absorbing device is set between the car body and holder to isolate vibration. It superiorly buffers vibration during the elevator running process. It reduces the car vibration and prompts the conformable travel to vast passengers. The combined car wall connection ensures mute effects in the car, the stable and enclosed air pressure.

▼ High Speed Serials Specification Table

Target market	The medium & high grade of the commercial buildings
Control system	VVVF
Traction machine	Permanent magnet synchronous & gearless
Door machine	VVVF door machine
Net car height	2800mm
Rated load(kg)	1050/1150/1250/1350/1600/2000
Rated speed(m/s)	2.5/3.0/4.0/5.0/6.0/7.0
Max.lighting height(m)	120/150/180/220/260/300
Max.group supervision No.	8

▼ Car Vibration System

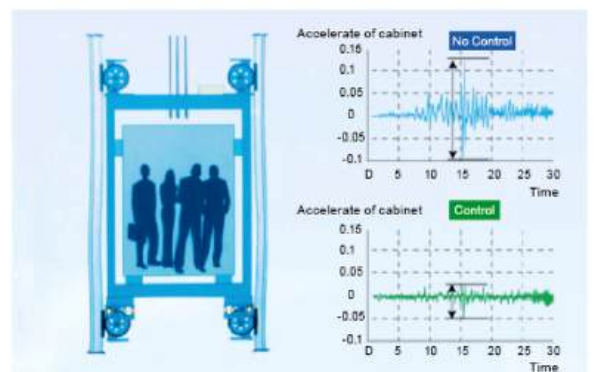

Rational arrangement of intellectual group supervision(Optional)

FI intellectual group supervision system takes several elevators as a whole. It arranges hall calling to give reasonable response. It shortens the passengers' average waiting time. It has real-time adaptation to change of passenger flow.



Traditional machine noise



Permanent magnet synchronous and gearless machine noise

Energy feedback technology(Optional)

Highly energy-saving energy feedback technology is based upon double-PWM control. It feeds back the pollution-less regenerated green electric energy that is originally consumed by energy-consumption resistance to other power equipment. It thus averagely saves over 30% of energy compared with the ordinary VVVF elevators. It completely satisfies the related national electric energy quality standards.

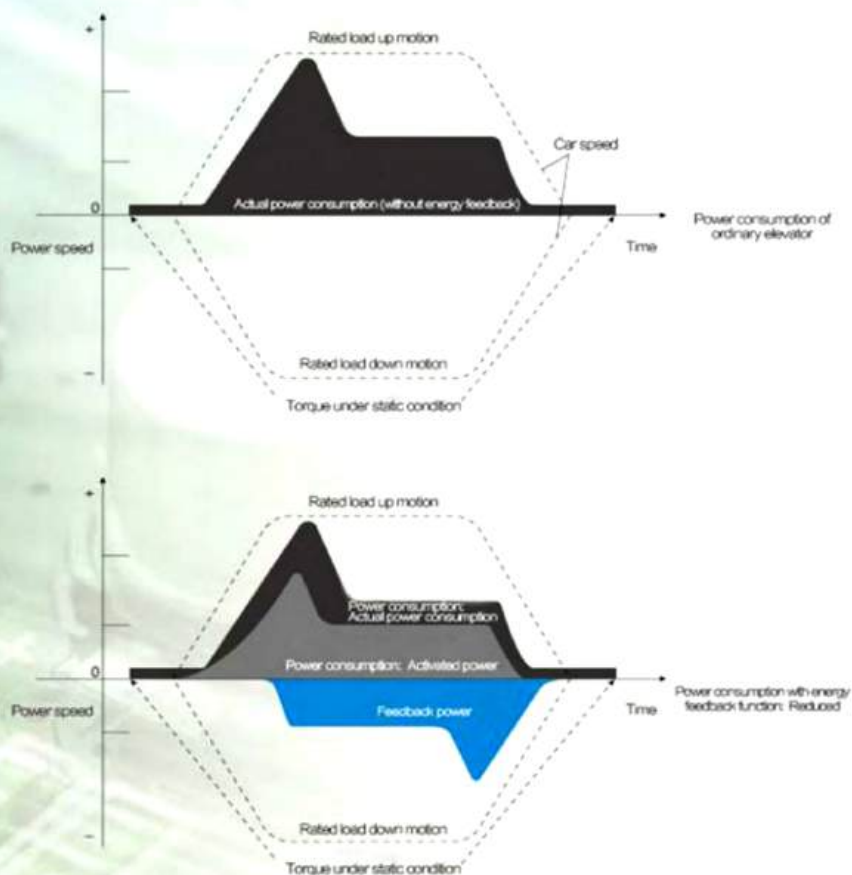



FAST

STABLE

SAFE

**To create the future of peace,
to solve the case.**

ELEVATOR is indispensable to modern life.
Transport of vertical elevator with one button can control. It is in the
precise and complex operation of the control card.
Determination of potential. A strong and fair execution.

GEARLESS TRACTION MACHINE



Max.Axle Load: 630kg
Motor Weight: 373kg
Working Duty: S5-60%ED
Ins.Class: 155(F)
Brake type: DZD1-653



Voltage: 380V
Suspension: 2:1
Weiht: 755kg
Max.Static Load: 11000kg
Load: 1000-2250kg
Speed: 1.0-2.5m/s



Voltage: 380V
Suspension: 2:1
Weiht: 160kg
Max.Static Load: 2000kg
Load: 450-630kg
Speed: 1.0-1.75m/s



Voltage: 380V
Suspension: 2:1
Weiht: 245kg
Max.Static Load: 3000kg
Load: 630-1050kg
Speed: 1.0-2.0m/s



Voltage: 400V
Suspension: 2:1
Weiht: 780kg
Max.Static Load: 6000kg
Load: 800-2500kg
Speed: 1.0-2.5m/s



Voltage: 400V
Suspension: 2:1
Weiht: 1480kg
Max.Static Load: 10000kg
Load: 1350-4000kg
Speed: 1.0-3.0m/s

SMALL MACHINE ROOM ELEVATOR



▼ It Fulfills Small Cost

Small volume traction machine combines with integrated controller, so that it makes the machine room size same with well size. It covers the equal area as that of the well. At the same time of reducing the machine room height it beautifies the building outlook. It fulfills super small standard of machine room space and building cost.

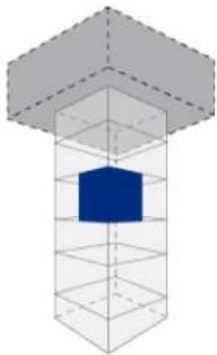

Machine room of the ordinary elevator

Saving up
50%
area
of the machine room



Machine room-less elevator

*All digital control

*Energy-saving permanent magnet synchronous and gearless traction machine

*Effective permanent magnet variable frequency door machine

*Individual decoration

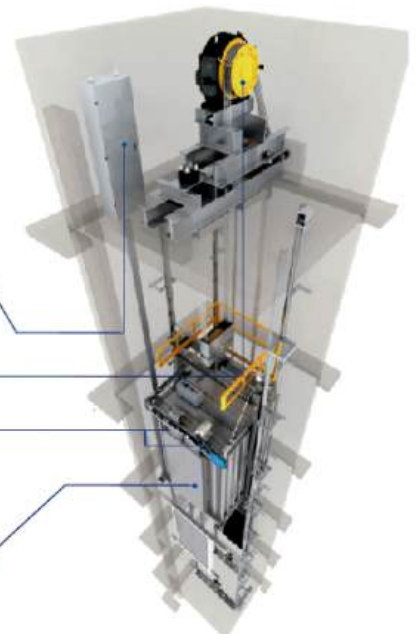

Small Machine Room Elevator Construction Sketch

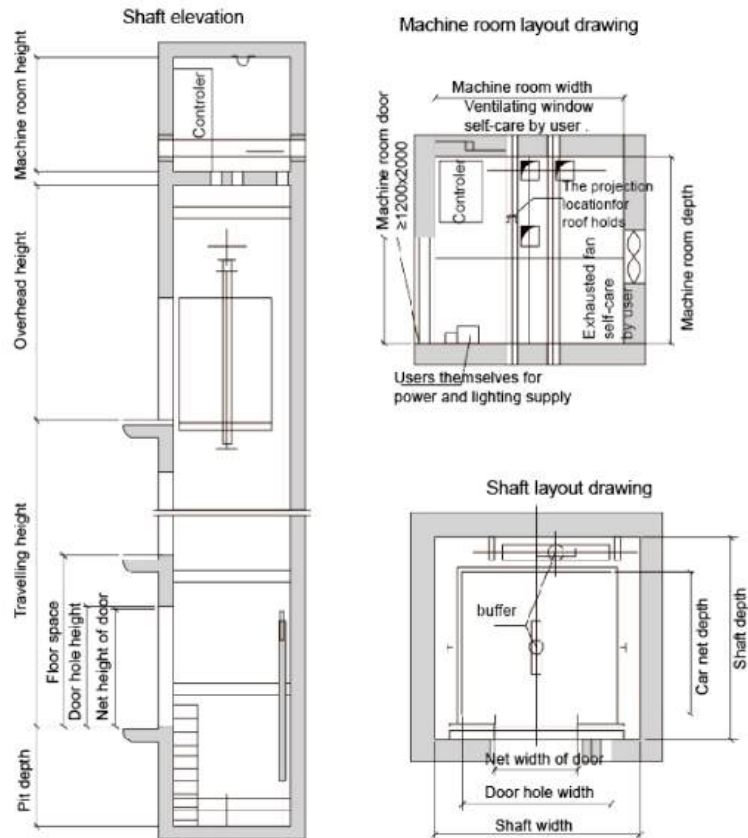

Small machine room elevator parameter table

Persons	Load (kg)	Speed (m/s)	Net size of car(mm)	Net size of door(mm) D.WxD.H	Shaft size(mm)			Machine room size(mm)	
			C.WxC.DxD.H	2P Central opening	H.WxH.D	HR.H	PIT	MR.WxMR.D	MR.H
6	450	1.0	1400*850*2300	800*2100	2000*1500	4000	1500	2000*1500	2500
		4400							
8	630	1.0	1400*1100*2300	800*2100	2000*1720	4200	1500	2000*1720	2500
		4400							
10	800	1.0	1400*1350*2300	800*2100	2000*1970	4200	1500	2000*1970	2500
		1.5/1.75				4400			
		2.0				1800			
		2.5				2000			
13	1000	1.0	1600*1450*2300 1100*2100*2300 (Residence/stretcher elevator)	900*2100	2200*2120 2100*2500 (Residence/ stretcher elevator)	4200	1500	2200*2120 2100*2500 (Residence/ stretcher elevator)	2500
		1.5/1.75				4400			
		2.0				1800			
		2.5				2000			
		3.0				2600			
		3.5				3100			
		4.0				3850			
16	1250	1.0	1900*1450*2300	1100*2100	2500*2150	4200	1500	2500*2150	2500
		1.5/1.75				4400			
		2.0				1800			
		2.5				2000			
		3.0				2600			
		3.5				3100			
18	1350	1.0	1900*1550*2300	1100*2100	2500*2250	4200	1500	2500*2250	2500
		1.5/1.75				4500			
		2.0				1800			
		2.5				2000			
		3.0				2600			
		3.5				3100			
21	1600	1.0	1900*1800*2300	1100*2100	2500*2500	4200	1500	2500*2500	2500
		1.5/1.75				4500			
		2.0				1800			
		2.5				2000			
		3.0				2600			
		3.5				3100			
26	2000	1.0	1900*1800*2300	1100*2100	2700*2500	6350	4300	2700*2500	2500
		1.5/1.75				4500			
		2.0				1500			

MACHINE ROOM-LESS ELEVATOR



Greatness in Trivialness Intellectual and Outstanding

SUNNY machine room-less elevator series resolves the restriction to the elevator in the construction, building cost, building design style, use range. At the same time of saving the space and cost, it provides the passengers with upper level intellectual, effective and stable travel.

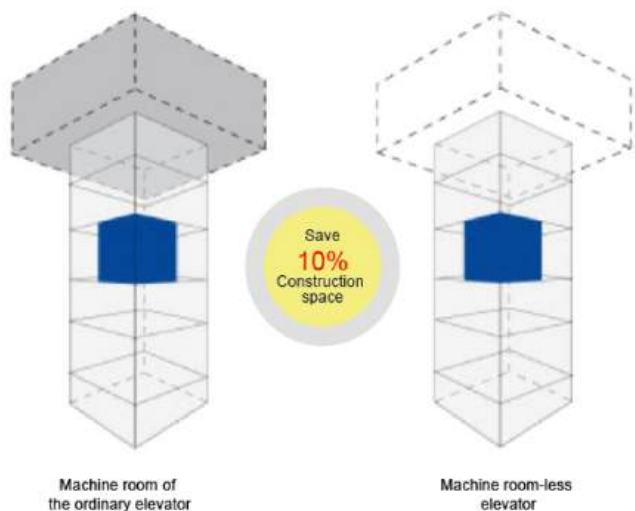

*Well optimal design has effectively save 10% construction areas.

*Being equipped with green drive and energy conservation device, energy conservation has reached 30%.

*Machine roomless concept makes the design of building more free and comfortable.



Machine Room-less Elevator Construction Sketch

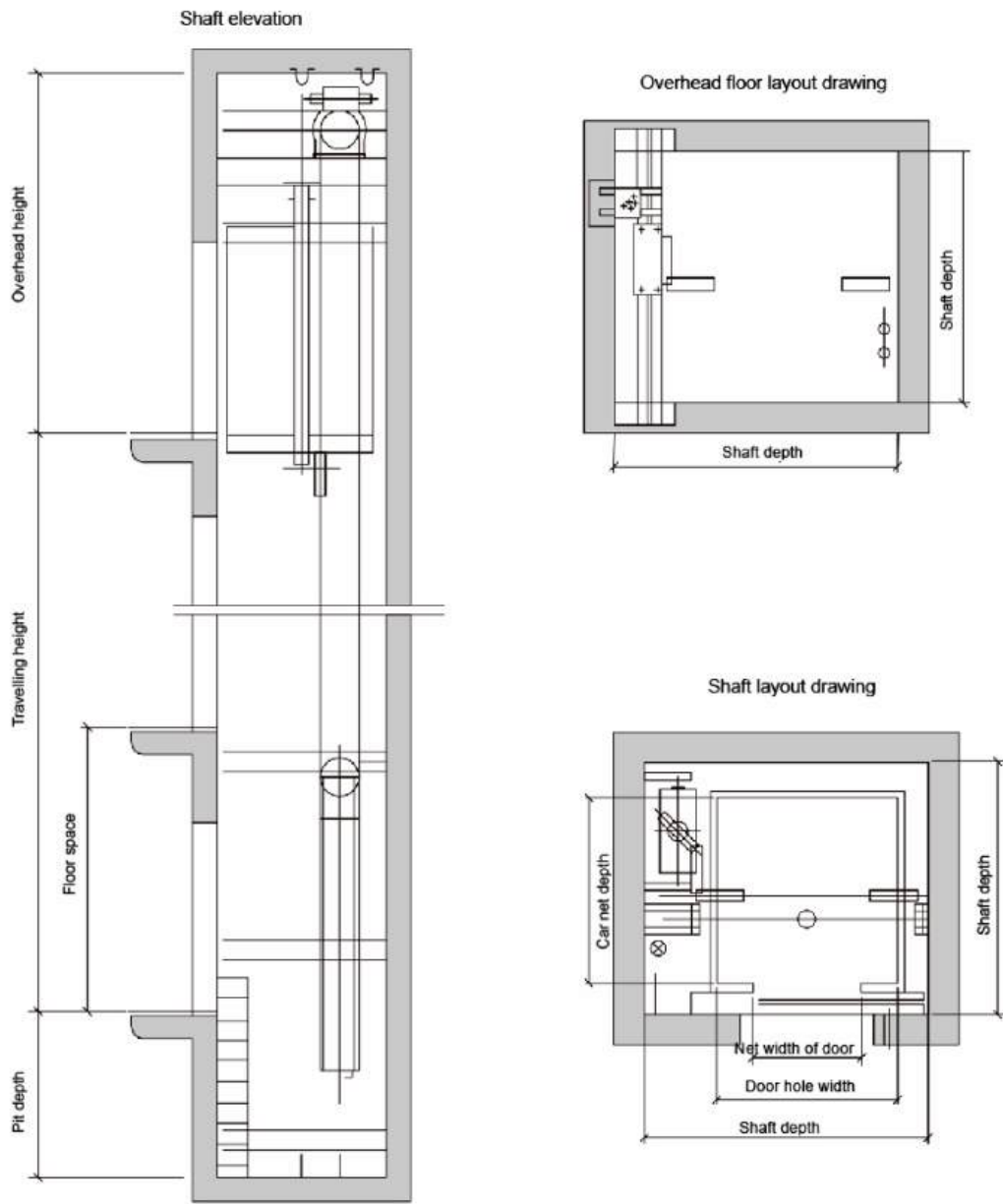

Machine room-less elevator parameter table

Persons	Load (kg)	Speed (m/s)	Net size of car(mm)	Net size of door(mm)	Shaft size(mm)		
			C.WxC.DxD.H	2P Central opening	H.WxH.D	HR.H	PIT
6	450	1.0	1100*1100*2300	800*2100	2050*1850	4200	1500
8	630	1.0	1400*1100*2300	800*2100	2250*1900	4200	1500
		1.5/1.75				4400	1600
10	800	1.0	1400*1350*2300	800*2100	2250*1950	4200	1500
		1.5/1.75				4400	1600
		2.0				4800	1800
		2.5					2000
13	1000	1.0	1500*1550*2300	900*2100	2350*2150	4200	1500
		1.5/1.75				4400	1600
		2.0				4800	1800
		2.5				4800	2000
21	1600	1.0	1900*1800*2300	1100*2100	2850*2400	4500	1500
		1.5/1.75				4700	1600
		2.0				4900	1800
		2.5				5100	2000
26	2000	1.0	1900*2200*2300	1100*2100	2900*2600	4500	1500
		1.5/1.75				4700	1600
		2.0				4900	1800

TECHNICAL STRENGTH

Effective, Speedy and High-End Intellectual Design

It gives first priority to effectiveness in vertical transport field. In order to fully optimize the service efficiency of the elevator system, TESLA elevator fulfills the intellectual managements such as multi-computer, modular and network control etc, through fully computerized intellectual control system.

It instantly feeds back the elevator running conditions. It provides the passengers with the most efficient gold-collar services.



Serial Communication Technology

It adopts the network communication, which brings great reduction of the wires, enhancement of the reliability and less installation period.

Microcomputer Group Supervision Management System

Duty on/off rush-hour running mode:It satisfies the running requirements in the rush hours of duty on/off the public occasions in the office building and etc.

Even operation mode:It adopts the minimized waiting period distribution principle with the prompt and reasonable elevator response.

Idle running mode:The elevators have been evenly distributed in the designated area to wait far call in indle times in order to guarantee the quick and timely response towards the outer balls.

Remote Control System Ensures Intelligent Supervision

Through wire or wireless communication, the operation status and success situation of passengers in elevators are real-time protected in remote control center. Malfunctions are excluded before occurrence and nip them in the bud to ensure the safety of passengers.



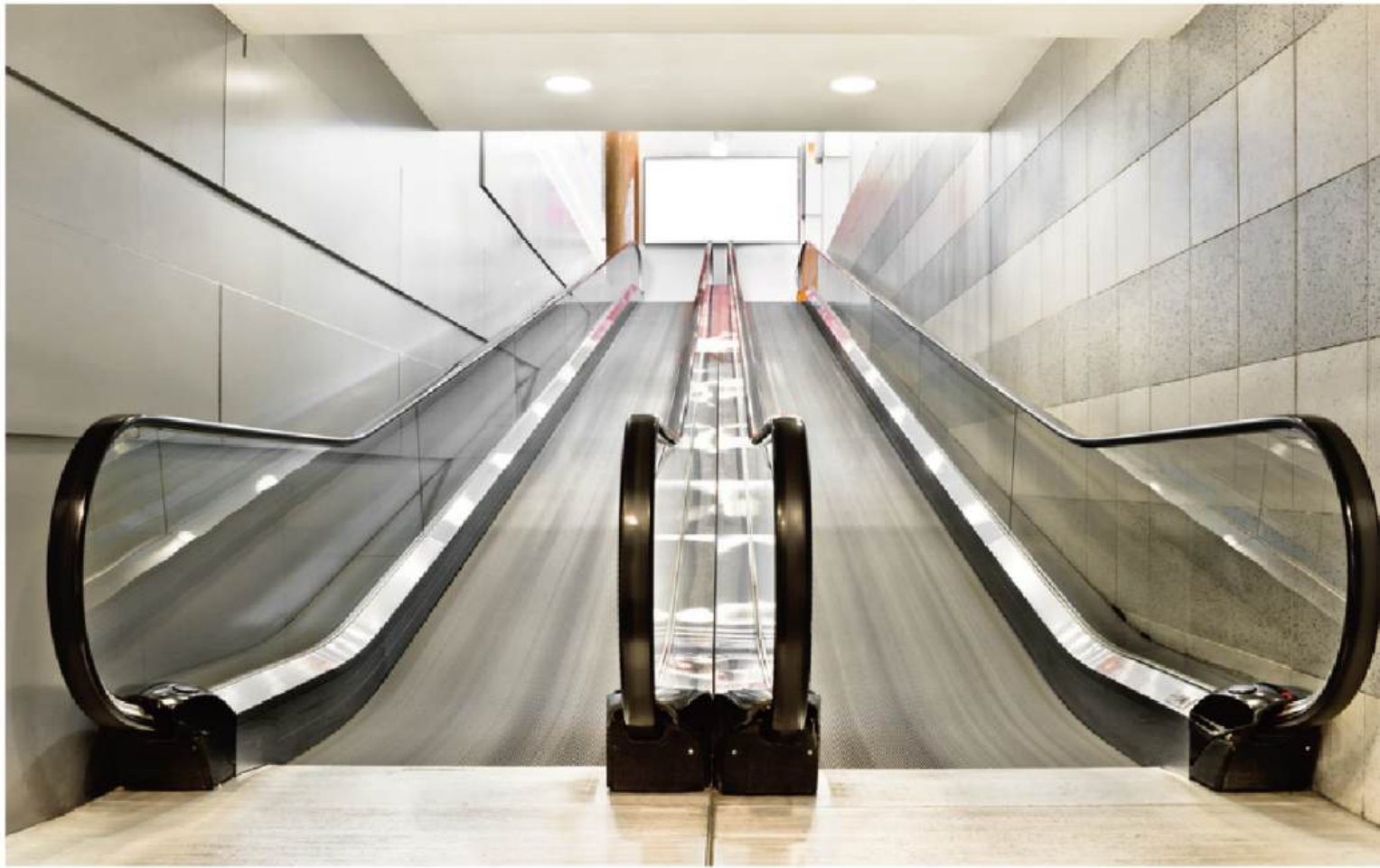

▼ Mute Braking Control Technology

- ⋈ Compared with the traditional voltage open-loop control.
- ⋈ It applies the more accurate current closed-loop control mode.
- ⋈ It controls various steps of action speed and braking torque of the brake.
- ⋈ It greatly reduces noise in brake action.
- ⋈ It enhances the comfortable travel.

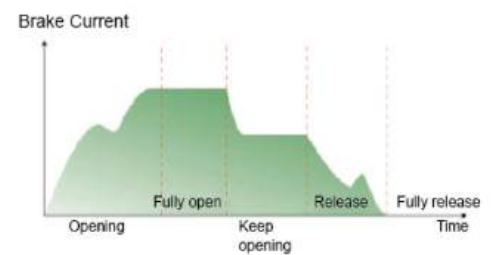

▼ Top Advanced Door Operator System

The door operator control system of SUNNY elevator applies dual control system. One group is controlled by main controller of control cabinet.

The other one is by door operator controller, which greatly reduces non-opening accidents due to trouble of door machine control.



TOP TECHNICAL

To Give You A Wholly New Experience



▼ Supervision System

Group supervision system of TESLA Elevator is high-speed network processing serve center. It can calculate the best elevator running mode in the building. The out-standing traffic control performance comes from parallel "fuzzy computing" method.

The processing system is based upon the quick and effective genetic algorithm. It can choose the best travel route for the passengers so that they get the prompt service under any of the traffic conditions.

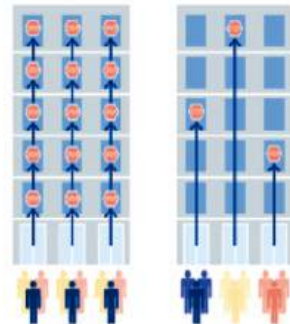

▼ Fingerprint Identification

Layer with finger print identification of the elevator control system is an utility model involves the electronic technology, and control the use of fingerprints identification residents elevator parked in the designated floor, make the multi-storey building entrance guard management improved, peaking time to other person into the building occupants harassment problems has solved.





The business field,high efficiency first, in order to fully optimize the service efficiency of business of elevator. TESLA by using the computer intelligent control system.Realizes the multi microcomputer module, network control and other intelligent management. The elevator operation provides instant feedback,offers the most efficient service for passengers.

✔ Intelligent Card(IC) System Realizes Scientific and Safe Management of Rights and Authority

In accordance with the requirements of users, intelligent IC card management system can be equipped to conduct real-name system or authority management, effectively avoid access of visitors and improve the safety of the building.



Through the contact less card reader at the entrance floor,automatically login uplink button.



After elevator arrived, it would automatically go to the target floor, bottions for other floors would not work even if you click them.

ENERGY SAVING

Energy Feedback Technology

Highly energy-saving energy feedback technology is based upon double-PWM control. It feeds back the pollution-less regenerated green electric energy that is originally consumed by energy-consumption resistance to other power equipment. It thus averagely saves over 30% of energy compared with the ordinary VVVF elevators. It completely satisfied the related national electric energy quality standards.

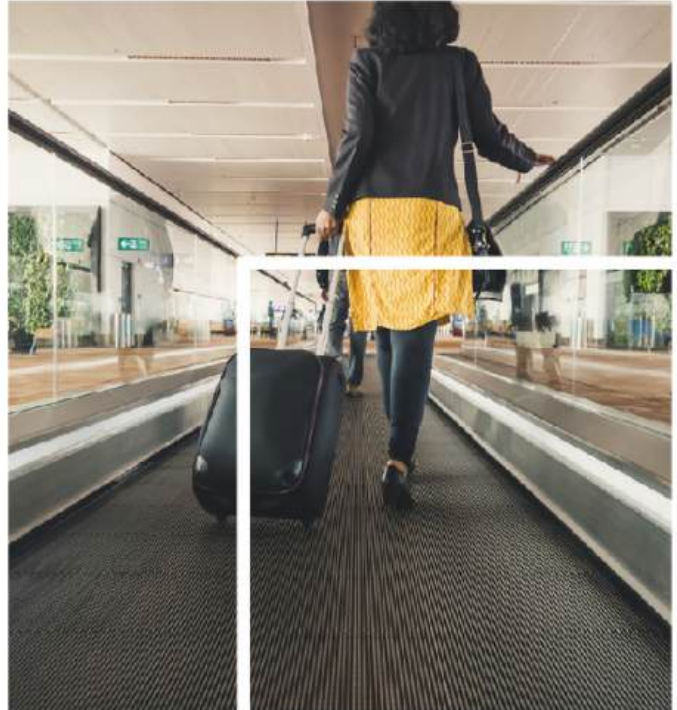
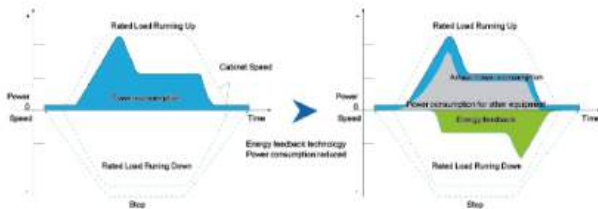

New Generation Permanent Magnet Synchronous Gearless Traction Machine

It can save over 40% of energy. It needs no grease renewal without oil pollution. Which brings peacefulness and refreshment.



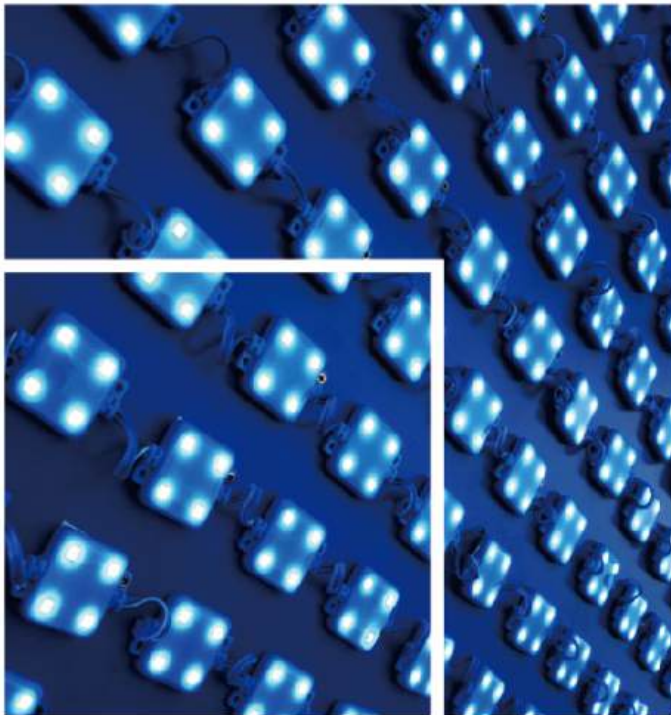

LED Automatic Lighting in the Car

It adheres to the product idea of TESLA Elevator. TESLA elevator innovatively applies LED car lighting device. It has the advantages, such as safe, effective, radiation-free, easy maintenance etc. It is a model example of energy-saving in modern and well-off life configuration of passenger elevator series includes automatic shut-off function of car enjoying and fan. It gives a full play of human-centered design to TESLA Elevator.



Five Advantages

- It is non-calorific converts over 90% of electric energy into optical energy.
- Longer service life and fewer power consumption.
- The elevators consume 20%~35% less of power.
- It does not add heavy metals during chip assembling and processing. It excludes any hazardous materials.
- It can be recycled and reused after being discarded.

High Speed Elevator Construction Sketch

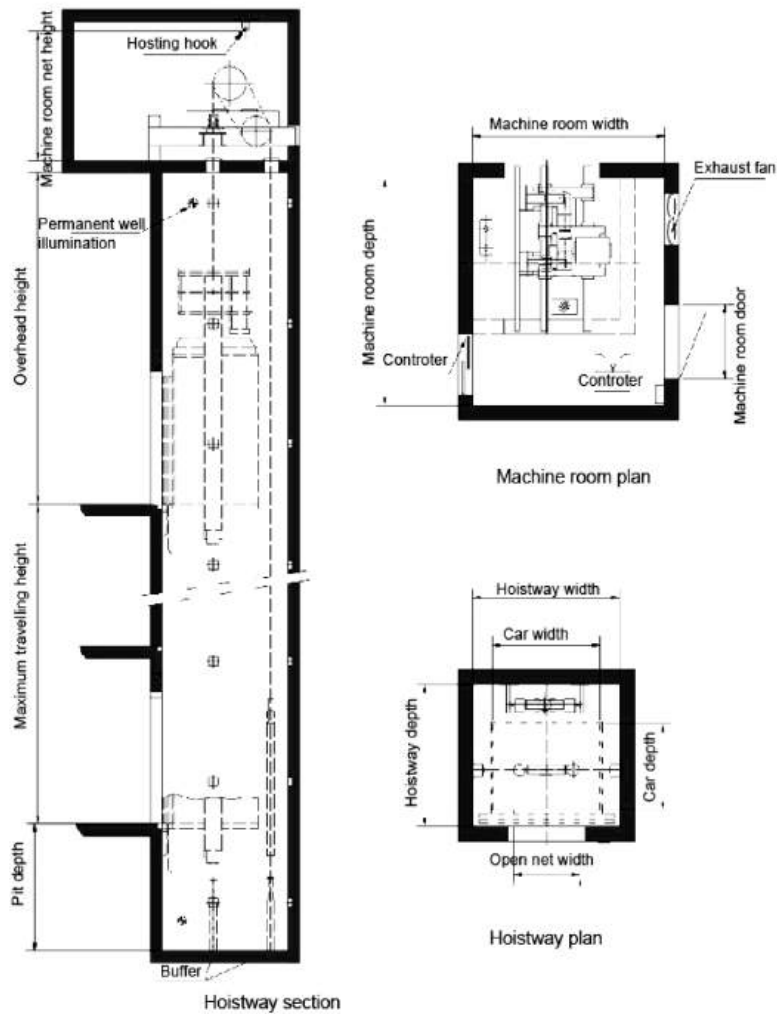

High speed elevator parameter table

Load (kg)	Speed (m/s)	Size of entrance (mm)	Size of car (mm)	Size of hoistway (mm)	Size of machine room (mm)	Overhead height (mm)	Pit depth (mm)	Max travelling height (mm)
800	2.5	800*2100	1400*1350*2450	2200*2250	3000*3700	5200	2200	150
1000	2.5	900*2100	1600*1400*2450	2200*2250	3000*3700	5200	2200	150
	3.0					5500	3100	150
	3.5					5800	3700	180
	4.0					6200	4000	180
1050	2.5	900*2100	1600*1500*2450	2200*2300	3000*3700	5200	2200	150
	3.0					5500	3100	150
	3.5					5800	3700	180
	4.0					6200	4000	180
1150	2.5	900*2100	1800*1400*2450	2450*2300	3200*3700	5200	2200	150
	3.0					5500	3100	150
	3.5					5800	3700	180
	4.0					6200	4000	180
1250	2.5	900*2100	1950*1400*2450	2600*2300	3200*3700	5200	2200	150
	3.0					5500	3100	150
	3.5					5800	3700	180
	4.0					6200	4000	180/210
1350	2.5	1100*2100	1950*1500*2450	2600*2350	3200*3700	5200	2200	150
	3.0					5500	3100	150
	3.5					5800	3700	180
	4.0					6200	4000	180/210
1600	2.5	1100*2100	1950*1750*2450	2600*2600	3200*4000	5200	2200	150
	3.0					5500	3100	150
	3.5					5800	3700	180
	4.0					6200	4000	150/210
2000	2.5	1100*2100	2000*1950*2450	2650*2800	3200*4000	5200	2200	150
	3.0					5500	3100	150
	3.5					5800	3700	180
	4.0					6200	4000	150/210

SQUARE OBSERVATION ELEVATOR



✔ Superior Car Wall

It adopt highly secure safety laminated glass. It is transparent. The passengers might appreciate the busy and prosperous city sight through the transparent car wall. Lamination layer in limited glass resists radiation. It buffers sound-wave vibration and isolates the sound. Large area car wall glass design shows smooth and beautiful lines. It beautifies the elevator car outline. Furthermore, the buildings are attractive.

✔ Super large viewing field

Full transparent lift car design can maximize the field of view. Through the visual extension,passengers can have a panoramic view of all the beautiful scenery.

✔ Multiple lift car shapes

Round,square and rhombic and other lift car shapes are optional, perfectly corresponding to different architectural styles.



Square Observation Elevator Construction Sketch

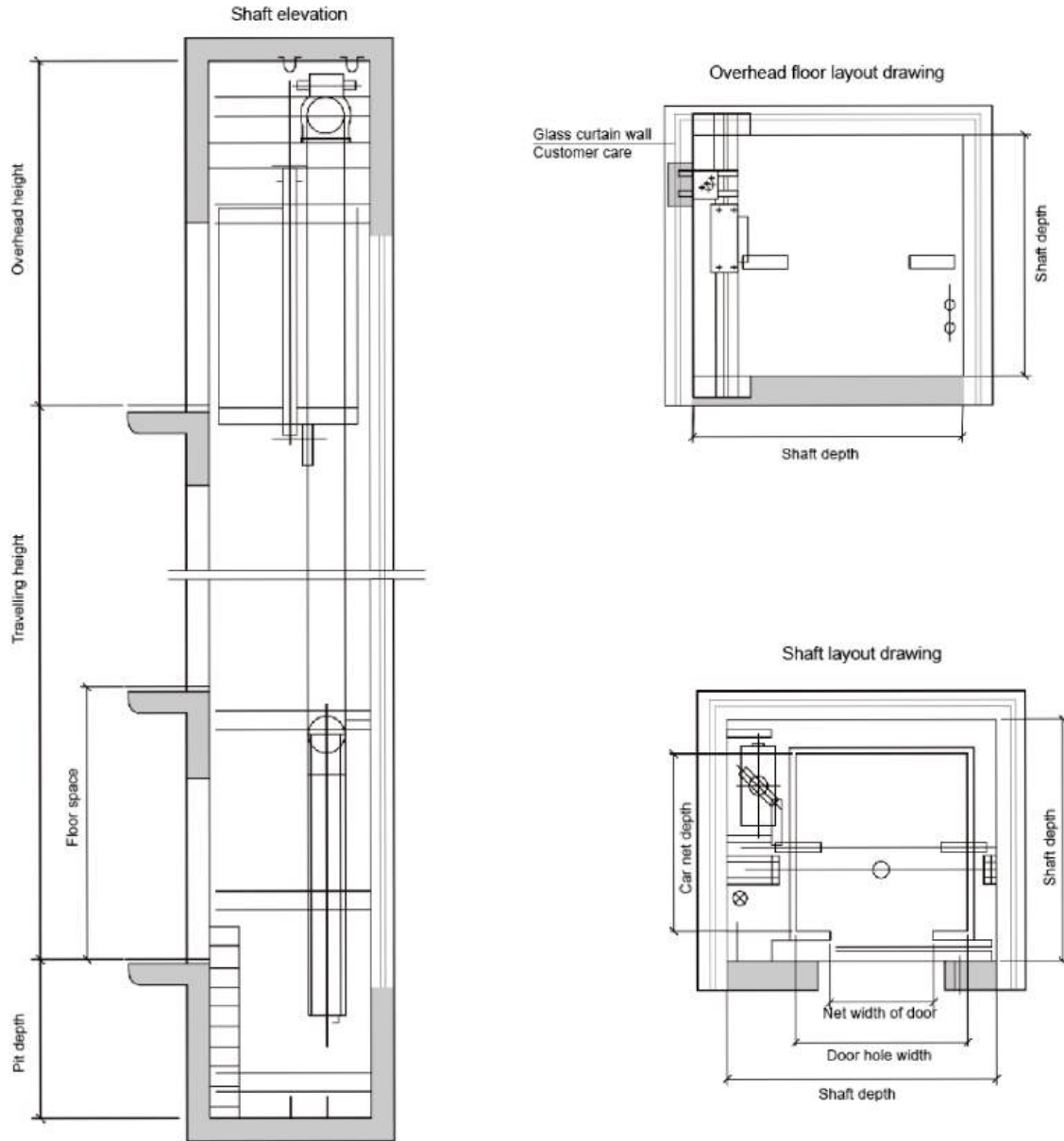

Square machine room/machine roomless elevator parameter table

Persons	Load (kg)	Speed (m/s)	Net size of car(mm)	Net size of door(mm)	Shaft size(mm)		
			C.WxC.DxD.H	2P Central opening	H.WxH.D	HR.H	PIT
6	450	1.0	1100*1100*2300	800*2100	2050*1850	4200	1500
8	630	1.0	1400*1100*2300	800*2100	2250*1900	4200	1500
		1.5/1.75				4400	1600
10	800	1.0	1400*1350*2300	800*2100	2250*1950	4200	1500
		1.5/1.75				4400	1600
		2.0				4800	1800
		2.5				4800	2000
13	1000	1.0	1500*1550*2300	900*2100	2350*2150	4200	1500
		1.5/1.75				4400	1600
		2.0				4800	1800
21	1600	2.5	1900*1800*2300	1100*2100	2850*2400	4800	2000
		1.0				4500	1500
		1.5/1.75				4700	1600
		2.0				4900	1800
26	2000	2.5	1900*2200*2300	1100*2100	2900*2600	5100	2000
		1.0				4500	1500
		1.5/1.75				4700	1600
		2.0				4900	1800

SEMICIRCLE OBSERVATION ELEVATOR



✔ Outer Glass Hood

It harmoniously combines with the building and surrounding. Panoramic elevator is part of the building. It also adds a mobile charming scene for the building.

✔ Outstanding sound insulation

The structure of the lift car is further optimized, which facilitates the elevator to achieve excellent sound insulation effect and customers to have quiet and steady using experience.

✔ Diversified decoration design

There are a series of optional materials and colors for hoistway doors, handles and lift car walls, thus truly realizing individualized customized services.

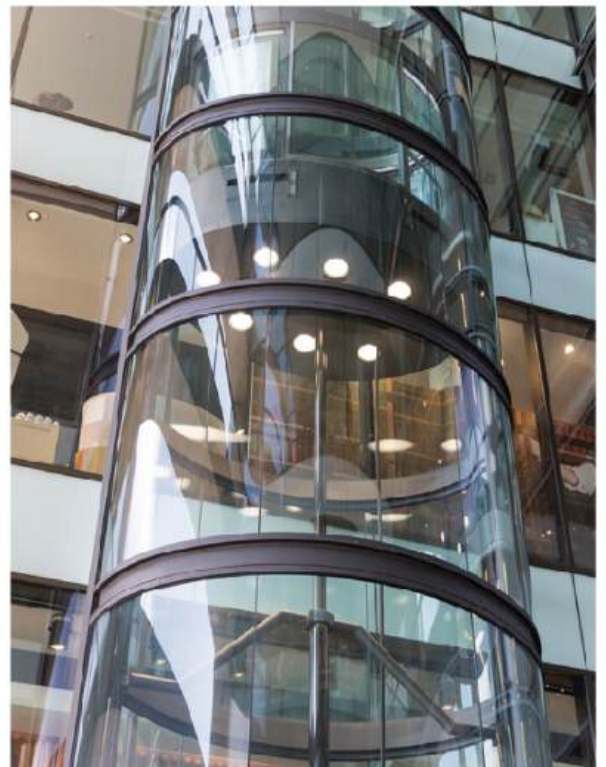

Semicircle Observation Elevator Construction Sketch

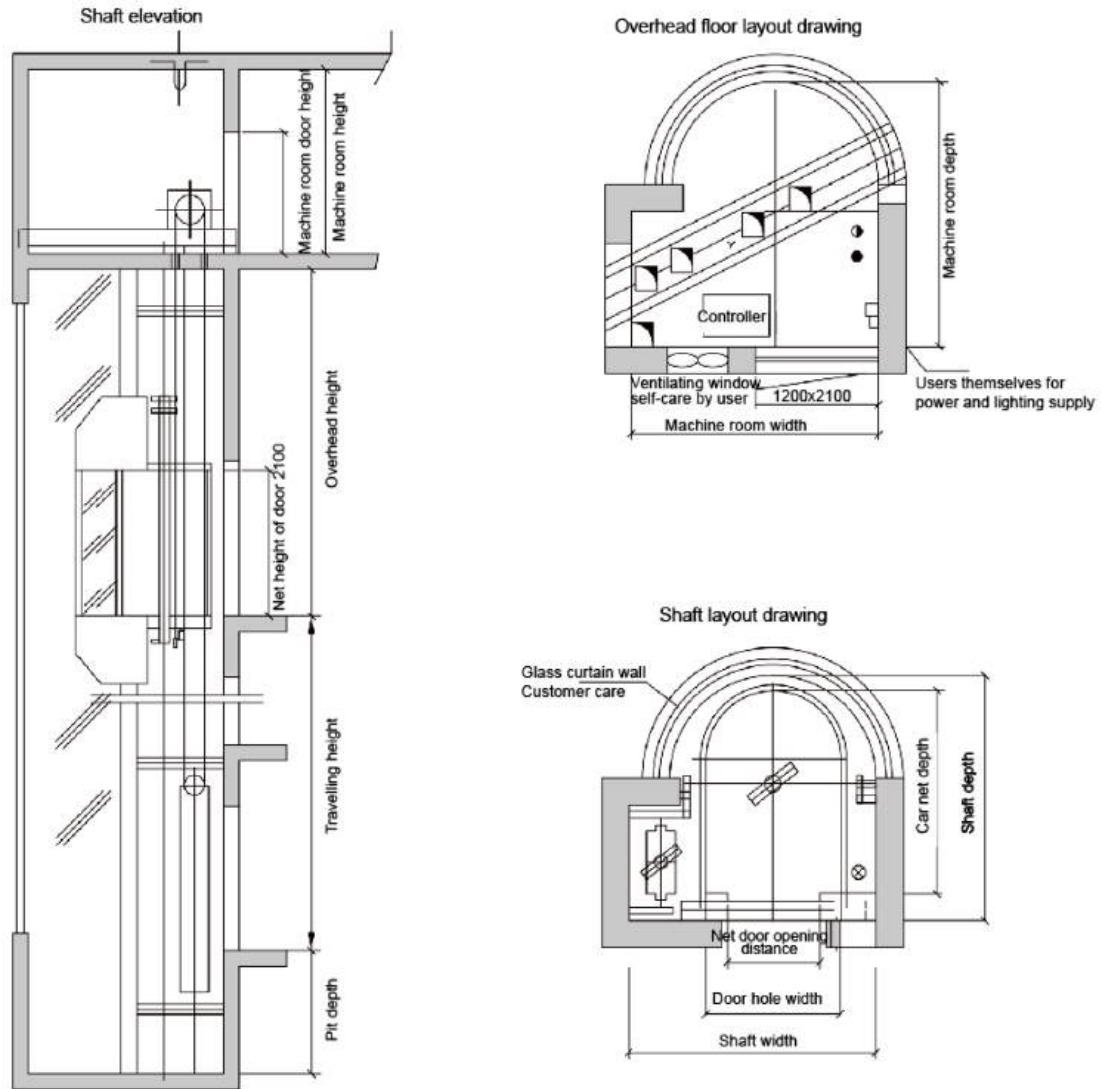

Semicircle machine room/machine roomless elevator parameter table

Persons	Load (kg)	Speed (m/s)	Net size of car(mm)	Net size of door(mm)	Shaft size(mm)			Machine room size(mm)	
			C.WxC.DxD.H	2P Central opening	H.WxH.D	HR.H	PIT	MR.WxMR.D	MR.H
8	630	1.0	1100*1600*2300	700*2100	2200*2185	4500	1500	2200*2185	2500
		1.5/1.75				4700	1600		
10	800	1.0	1200*1800*2300	800*2100	2300*2355	4500	1500	2300*2355	2500
		1.5/1.75				4700	1600		
		2.0				4900	1800		
		2.5				5100	2000		
13	1000	1.0	1300*1950*2300	900*2100	2400*2535	4500	1500	2400*2535	2500
		1.5/1.75				4700	1600		
		2.0				4900	1800		
		2.5				5100	2000		
16	1250	1.0	1400*2150*2300	900*2100	2500*2600	4500	1500	2500*2600	2500
		1.5/1.75				4700	1600		
		2.0				4900	1800		
		2.5				5100	2000		
18	1350	1.0	1500*2150*2300	1000*2100	2600*2600	4500	1500	2600*2600	2500
		1.5/1.75				4700	1600		
		2.0				4900	1800		
		2.5				5100	2000		
21	1600	1.0	1500*2450*2300	1000*2100	2600*2900	4500	1500	2600*2900	2500
		1.5/1.75				4700	1600		
		2.0				4900	1800		
		2.5				5100	2000		
26	2000	1.0	1700*2600*2300	1100*2100	2800*3050	4500	1500	2800*3050	2500
		1.5/1.75				4700	1600		
		2.0				4900	1800		
		2.5				5100	2000		

HOSPITAL ELEVATOR



Warm Concern A Beautiful Humanity World

TESLA hospital elevators are not just used in delivering passengers. Because of its use particularity, it has special and strict requirements to the elevator use properties. **TESLA** hospital elevator can accurately control the elevators' running speed. It brings about the smooth and comfortable travel.

TESLA hospital elevator lays special importance upon the humane design. It fully optimizes the car structure. It satisfies the clients' use requirements to the greatest extent. It creates a peaceful and graceful space for vast passengers.

TESLA hospital elevator satisfies the needs of emergency patients' delivery. It applies humanization design and is equipped with a full set of top equipments. It is smooth and comfortable in running.

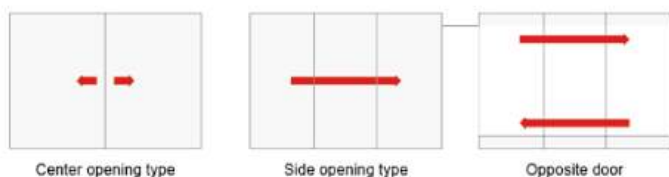

Hospital Elevator Construction Sketch

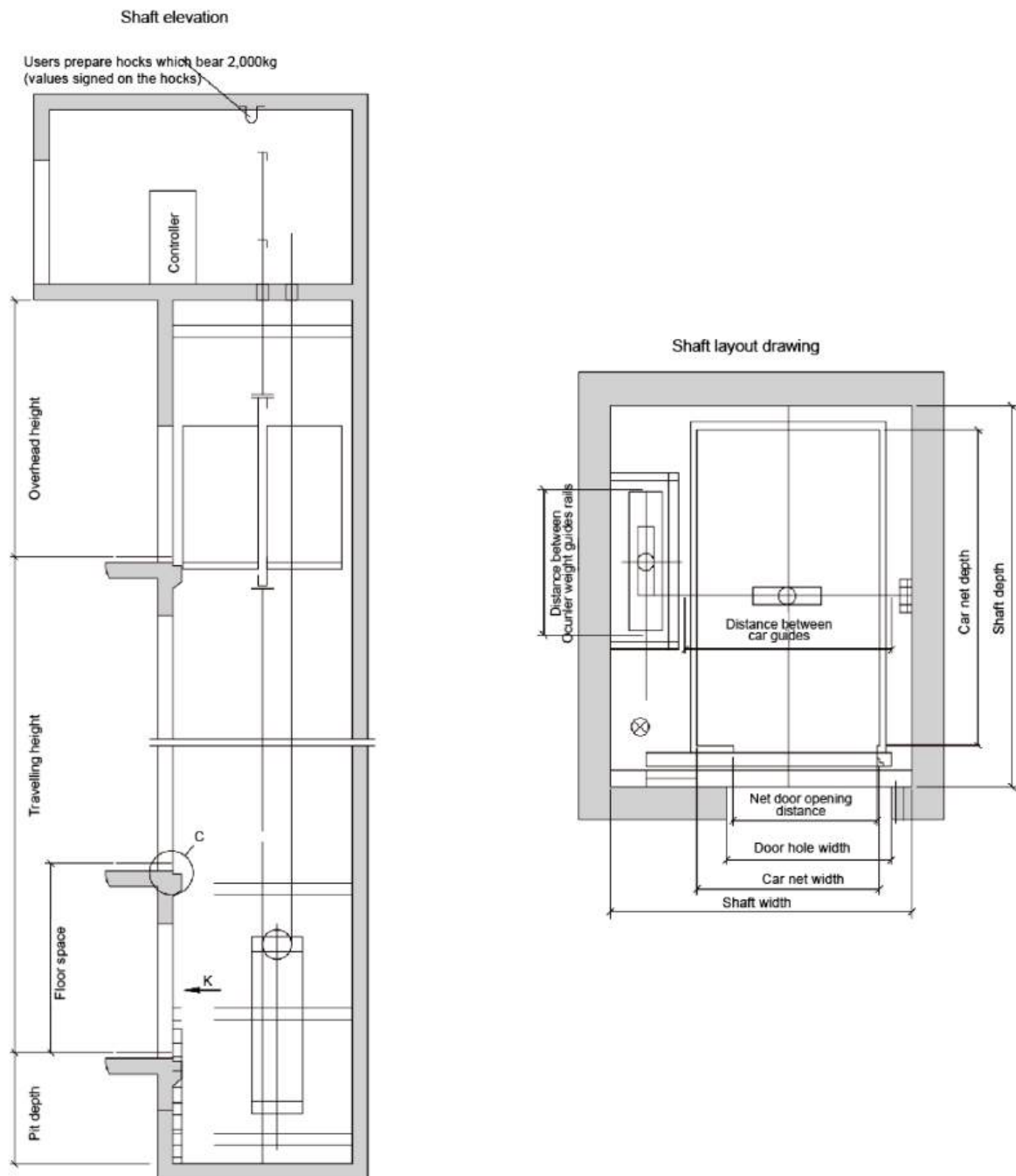

Hospital elevator parameter table

Persons	Load (kg)	Speed (m/s)	Net size of car(mm)	Net size of door(mm)	Shaft size(mm)			Machine room size(mm)	
			C.Wx C.DxD.H	D.WxD.H	H.WxH.D	HR.H	PIT	MR.WxMR.D	MR.H
21	1600	1.0	1400*2400*2300	1100*2100	2550*2900	4500	1500	2550*2900	2500
		1.5/1.75				4700	1600		
		2.0				4900	1800		
		2.5				5100	2000		
24	1800	1.0	1600*2400*2300	1200*2100	2750*2900	4500	1500	2750*2900	2500
		1.5/1.75				4700	1600		
		2.0				4900	1800		
		2.5				5100	2000		
26	2000	1.0	1700*2400*2300	1200*2100	2850*2900	4500	1500	2850*2900	2500
		1.5/1.75				4700	1600		
		2.0				4900	1800		
		2.5				5100	2000		

HOME ELEVATOR



✔ Your Perfect Life is Comfortable and Relaxing

The humanization design decorates your noble life space. We enhance your life grade in the times of high & new tech. TESLA home elevator brings about a more convenient and high-grade life.

It displays the outstanding properties in a limited space. It has no machine room. Extremely small top-floor height can match with various old and new residences. Relying on the standard track installation system, the elevator can be installed more quickly and conveniently. In addition, the smooth start and leveling system bring about the rare stable elevator operation.

Therefore you feel more comfortable in the elevator travel.

✔ The Characteristics of Home Elevator

*No need of traditional machine room, without any construction cost increased. Specially designed rucksack frame for the home elevator with traction ratio 2:1 VVVF drive technology, TESLA home elevator appropriate micro processing control.

*Slide + roller composite guide shoe.

*The appropriate traction machine bracker is fixed on the guide rail.

The building will not have any load.

*We apply 220V single-phase home elevator special machine.

*Automatic special door machine, synchronous timing belt transmission, TUV CE Certification passed.

*Comply with home elevator national standard GB/T21739-2008.



Home Elevator Construction Sketch

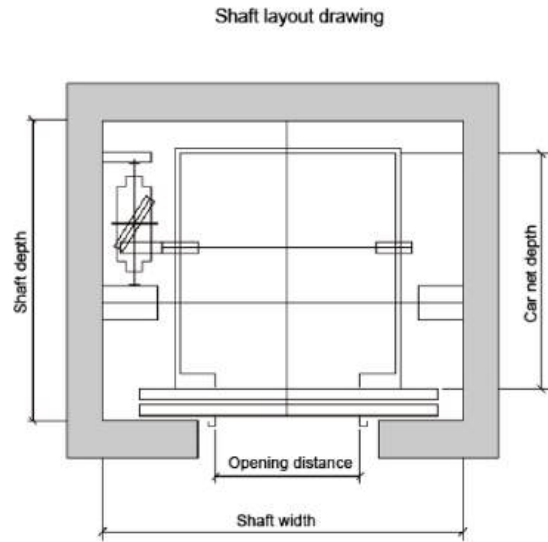
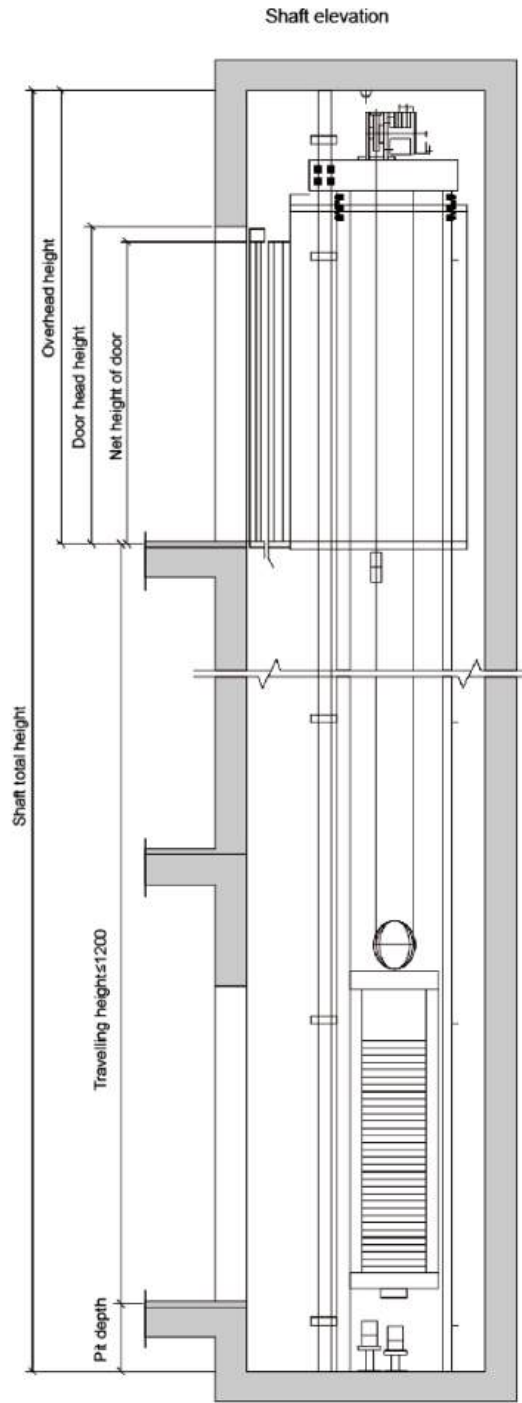





Home elevator parameter table

Persons	Load (kg)	Speed (m/s)	Net size of car(mm)	Net size of door(mm)	Shaft size(mm)		
			C.WxC.DxD.H	D.WxD.H	2P Central opening	H.WxH.D	HR.H
3	260	0.4	800*1150*2200	700*2000 Side door	1400*1500	3500	800
4	320	0.4	950*1300*2200	700*2000	1600*1600	3500	800
5	400	0.4	1200*1300*2200	800*2000	1850*1600	3500	800





PERFECT FUNCTION

★ Standard Function

 Travel Function	VVVF drive	Motor rotating speed can be precisely adjusted to get smooth speed curve in lift start, travel and stop and gain the sound comfort.
	VVVF door operate	Motor rotating speed can be precisely adjusted to get the more gentle and sensitive door machine start/stop.
	Independent running	The lift can not respond to outer calling, but only respond to the command inside the car through the action switch.
	Automatic pass without stop	When the car is crowded with the passengers or the load is otiose to preset value, the car will automatically pass the calling landing in order to keep maximum travel efficiency.
	Automatically adjust door opening time	Door-open time can automatically adjusted according to the difference between landing calling or car calling
	Reopen with hall call	In the door shutting process, press reopen with hall call button can restart the door.
	Express door closing	When the lift stops and opens the door, press door-shut button, the door will be closed immediately.
	Car stops and door open	The lift decelerates and levels, the door only opens after the lift comes to a complete stop.
	Command register cancel	If you press the wrong floor command button in the car, twice continuous pressing of same button can cancel the register.
 Safety Function	Photocell protection	In the door open and shut period, infrared light that covers the whole door height is used to probe the door protection device of both the passengers and objects.
	Designated stop	If the lift can not open the door in the destination floor out of some reason, the lift will close the door and travel to the next designated floor.
	Overload holding stop	When the car is overload, the buzzer rings and stops the lift in the same floor.
	Anti-stall timer protection	The lift stops operation due to slippery traction wire rope.
	Start protection control	If the lift does not leave door zone within the designated time after it gets started, it will stop the operation.
	Inspection operation	When the lift enters into inspection operation, the car travels at inching running.
	Fault self-diagnosis	The controller can record 62 latest troubles so as to quickly remove the trouble and restore the lift operation.
	Repeated door closing	If the lift can not close the door due to certain obstacle or interference, the lift will reopen, or re-shut the door until sundries are eliminated.
	Up/down aver-run and final limit protection	The device can effectively prevent from the lift's surging to the top or knocking the bottom when it is out of the control. It results in the more safe and reliable lift travel.
	Down over-speed protection device	When the elevator downs 1.2 times higher than the rated speed. This device will automatically cut off control power, stop the motor running so as to stop lift down at over-speed. If the lift continues to down at over-speed, and the speed is 1.4 times higher than rated speed, safety tongs act to force the lift stop in order to ensure the safety.
	Upward over-speed protection device	When the lift ups 1.2 times higher than rated speed, the device will automatically decelerate to brake the lift.
 Man-machine Interface	Micro-touch button for car call and hall call	Novel micro-touch button is used for operation panel command button in the car and landing calling button.
	Floor and direction indicator car	The car shows the lift floor location and current travel direction.
	Floor and direction indicator	The landing panel shows the lift floor location and current travel direction.

 Emergency Function	Emergency car lighting	Emergency car lighting automatically activated when there is power failure.
	Inching running	When the elevator enters into emergency electric operation, the car travels at low speed inching running.
	Five way intercom	Communication amid car, car top, elevator machine room, well pit and rescue duty room through walkie-talkie.
	Bell	In emergency conditions, if bell button above car operation panel is continuously pressed, electric bell rings on top of the car.
	Fire emergency return	If you start key switch in main landing or monitor screen, all the callings will be cancelled. The elevator directly and immediately drives to the designated rescue landing and automatically opens the door.
 Energy-saving Function	Car ventilation, light automatic shut off	If there is no calling or command signal within the stipulated time, the car fan and lighting will be automatically closed in order to save the energy.
	Remote shut-off	The elevator can be called to main landing (after finishing the service) through the key switch and automatically exists the service.

★ Optional Function

 Emergency Function	Leveling when power failure	In normal power failure, the chargeable battery supplies the elevator to power. The elevator drives to the nearest landing.
 Travel Function	Anti-nuisance	In the light elevator load, when three more commands appear, in order to avoid the unnecessary parking, all the registered callings in the car will be cancelled.
	Open the door in advance	When the elevator decelerates and enters into door open zone, it automatically opens the door to enhance the travel efficiency.
	Direct parking	It completely accords with distance principle with no crawling in the leveling. It greatly enhances the travel efficiency.
	Group control function	When three or more same model lift groups are controlled in use, the lift group can automatically choose the most appropriate response. It avoids the repeated lift parking, reduces the passengers' waiting time and increases the travel efficiency.
	Duplex control	Two sets of same model elevators can unanimously respond the calling signal through the computer dispatch. In this way, it reduces the passengers' waiting time to the greatest extent and enhances the travel efficiency as well.
	On-duty peak service	Within the preset on-duty time, upward transport from the home landing is extremely busy. The lifts are continuously dispatched to the home landing in order to satisfy on-duty peak service.
	Off-duty peak service	Within the preset off-duty period, the lifts are continuously dispatched to top floor in order to satisfy off-duty peak service.
	Door open time extending	Press special button in the car, the lift door keeps open for certain period of time.
	Car arrival gong	Arrival tong in the car top announces that the passengers arrive.
 Man-machine Interface	Voice announcer	When the elevator normally arrives, voice announcer informs the passengers about the relevant information.
	Car assistant operation box	It is used in the large loading weight lifts or the elevators with crowded passengers so that more and more passengers can use the car.
	Operation box for the handicapped	It is convenient for the wheelchair passengers and those who have vision problems.
	Intelligent calling service	The car command or hoist-way calling can be locked or connected through special Intelligent Input.
	IC card control function	All (partial) landings can only input car commands through IC card after authorization.
 Monitor Function	Remote monitor	The elevator long-distance monitor and control can be fulfilled through modem and telephone. It is convenient for the factories and service units to timely know the travel conditions of every elevator and promptly take the corresponding measures.
	Remote control	The life car have independent travel according to the specific requirements through operation monitor screen (optional).
	Camera function in the car	The camera is installed in the car to monitor the car conditions.

FREIGHT ELEVATOR



✔ A loading giant that can release more and more cargo pressures for you

TESLA freight lift serial fully utilizes the advanced and fully computerized control technology. It employs the well-developed VVVF control system of TESLA elevator. It is simple in structure and convenient in repair and maintenance. It fulfills a qualitative leap in the aspects of the signal transmission and running control. It brings about the more stable and reliable system, the lower noise, the smoother running, the more accurate leveling. It is more and more easy for the goods entry and exit. In addition, TESLA freight lift serial can offer the micro-processor. The high speed running capabilities and expansion interface ensure to satisfy the special requirements from broad users.

✔ Light curtain protection

Several protective light curtains are formed at the entrance of the elevator, which sensibly detects and responds to any objects that intrude into the detecting scope. The safety of human and cargoes are guaranteed.

✔ The extremely humane operation

It is equipped with fully automatic collective selective function. It can fulfill operation with driver / without driver. The operation box specially and additionally sets "door-shut delay" button in the operation box. Door-shut delay time can be flexibly adjusted at site according to the requirements. You feel more at ease at loading and unloading the goods out of its humane setting.



Freight Elevator Construction Sketch

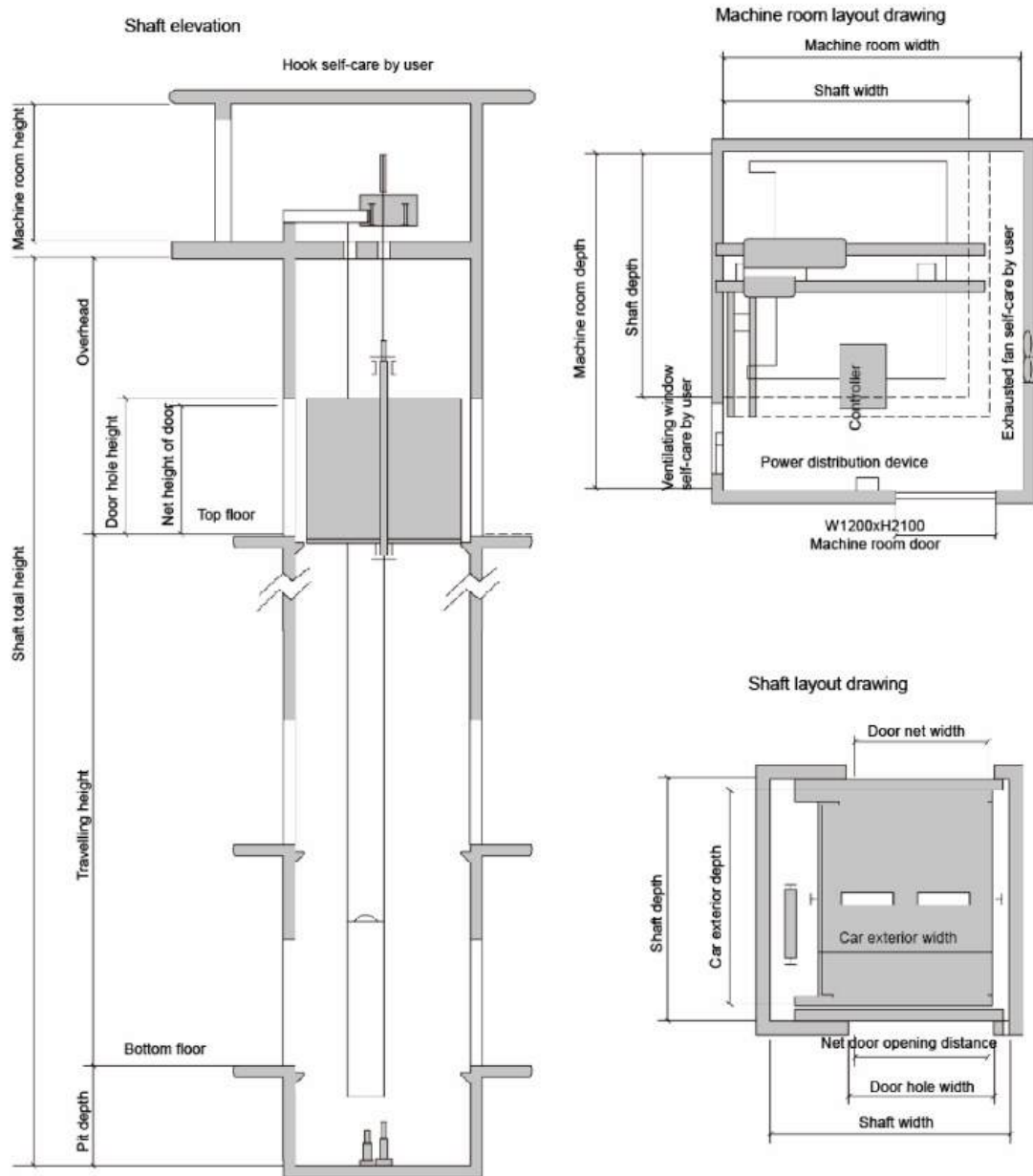

Freight elevator parameter table

Load (kg)	Speed (m/s)	Net size of car(mm)	Net size of door(mm)	Shaft net size(mm)			Machine room net size(mm)		Door open type
		C.Wx C.DxD.H	D.WxD.H	width x depth	Overhead height	Pit depth	width x depth	height	
630	0.5	1200*1500*2200	1100*2100	2100*1860	4200	1500	2500*3000	2200	Two panel side opening
1000	0.5	1500*1800*2200	1200*2100	2250*2160	4200	1500	3000*3000	2200	Two panel side opening
2000	0.5	1570*2900*2200	1500*2100	2700*3260	4200	1500	3500*3000	2500	Two panel side opening
	1.0				4500	1500			
	1.5	2850*2660		4500	1600				
	2.0			4800	1800				
3000	0.25	2070*3050*2200	1800*2100	3300*3410	4500	1500	3800*4200	2500	Four panel center opening
	0.5								
3200	1.0	2070*3100*2200	1800*2100	3300*3460	4500	1500	3800*4200	2500	Four panel center opening
5000	0.25	2800*3400*2500	2000*2200	4200*3800	5000	1600	4200*3800	2800	Four panel center opening
	0.5								
7000	0.25	3000*4200*2500	2600*2400	4500*4600	5000	1600	4500*4600	2800	Four panel center opening
	0.5								
10000	0.25	3070*5760*2500	2600*2400	4900*6200	5000	1600	4900*6200	2800	Four panel center opening

CAR ELEVATOR



Perfect Space for Cars

We develop and produce TESLA automobile elevator through absorption, transformation and enhancement by introducing the world's, well-developed automobile elevation technology. The powerful technical capacity of TESLA reduces the traction system burden due to uneven force to the elevator car. It solves the technical obstacle of shaking elevator car due to noise production. It optimizes the characteristics of the product series.



∧ Dual operation panels design(Optional)

There are two operation box in the car. Therefore the driver can operate the elevator in the car without slapping out of it.



∧ Special-purpose circuit control and display system

Special circuit control and display system is convenient for the drivers inside/outside the car.



∧ Front-and-rear opening elevator car

The elevator car sets front/rear door opening which is more convenient for the safety sector and for the cars to enter into/exit from the elevator cars.

Car Elevator Construction Sketch

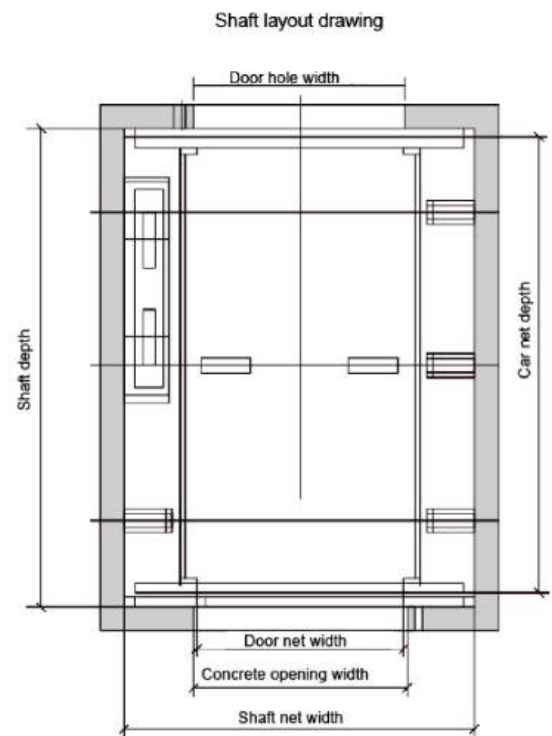
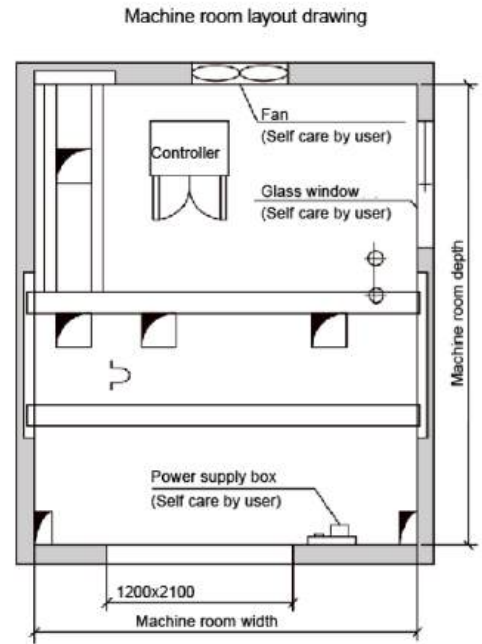
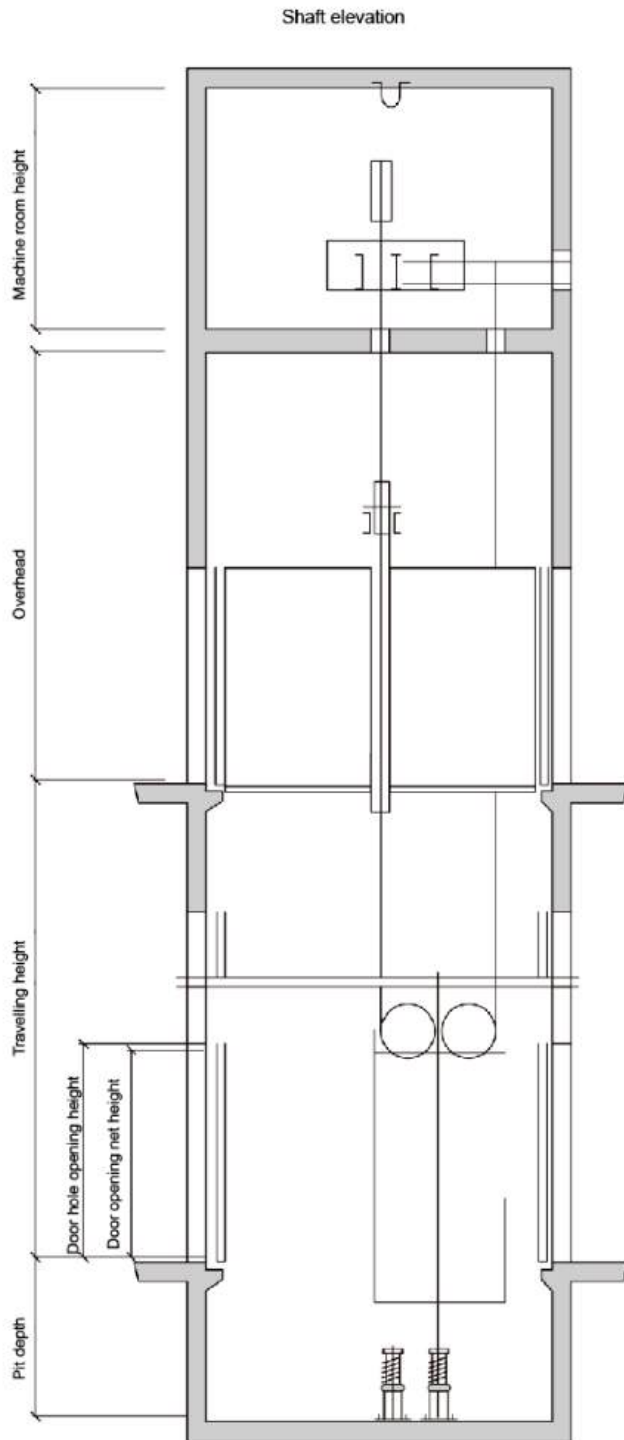

Car elevator parameter table

Load (kg)	Speed (m/s)	Door open type	Net door opening widthxheight(mm)	Exterior size of car widthxdepth(mm)	Shaft net size(mm)			Machine room net size(mm)
					widthxdepth	pit depth	overhead height	widthxdepthxheight
3000	0.25/0.5	Four Panel Center Opening	2400*2200	2700*5800	4100*6160	1600	4800	4100*6160*2500
5000	0.25 0.5	Four Panel Center Opening	2600*2200	3500*7200	4750*7560			4750*7560*2500

Cabin Car Design

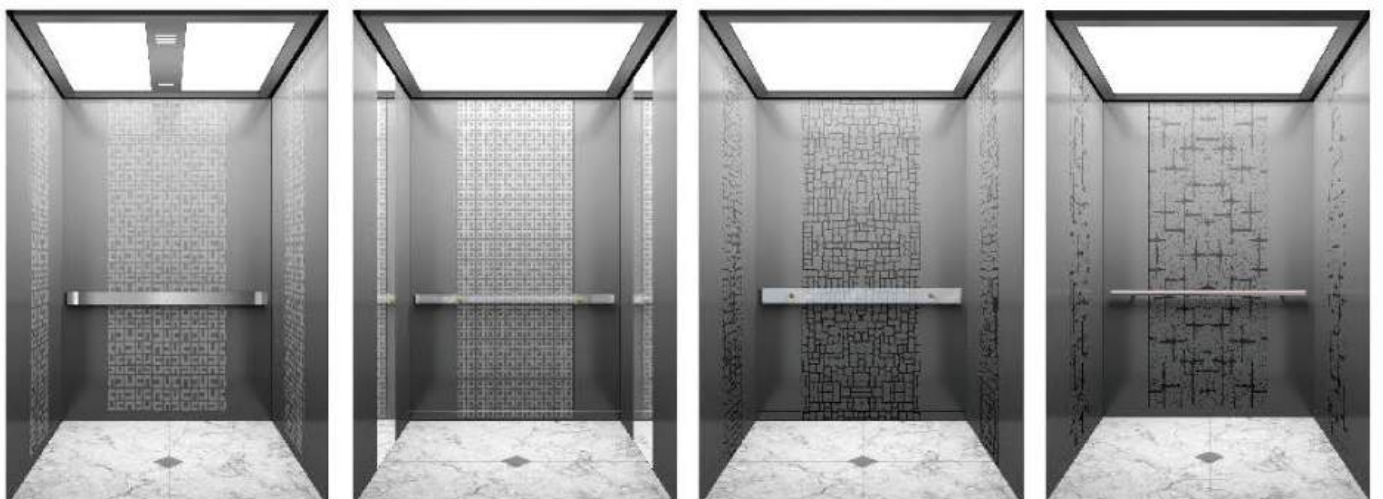
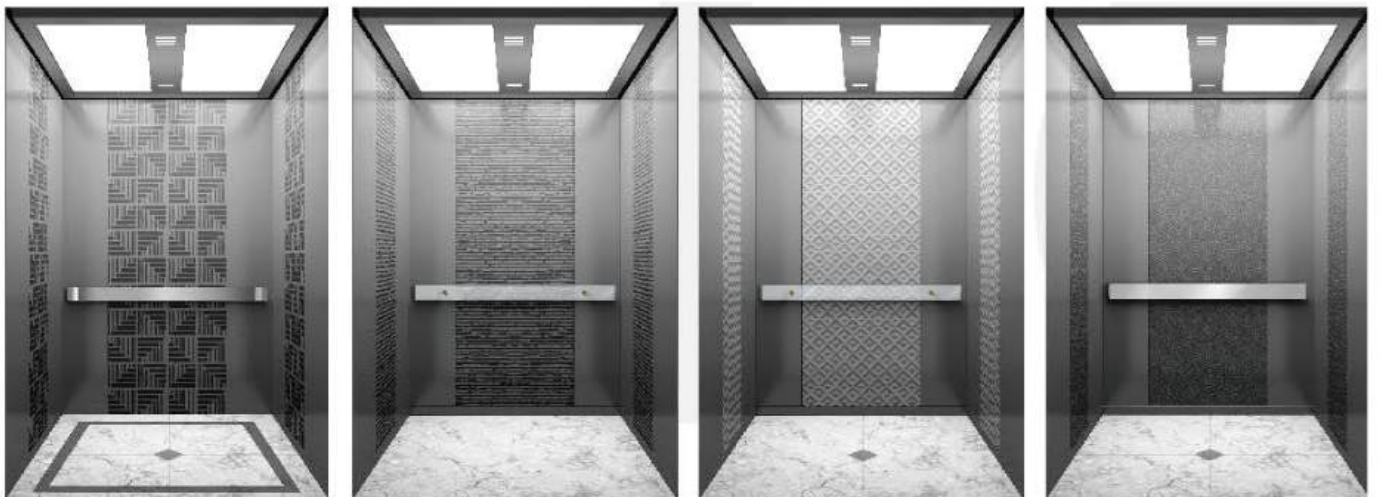

Cabin Car Design

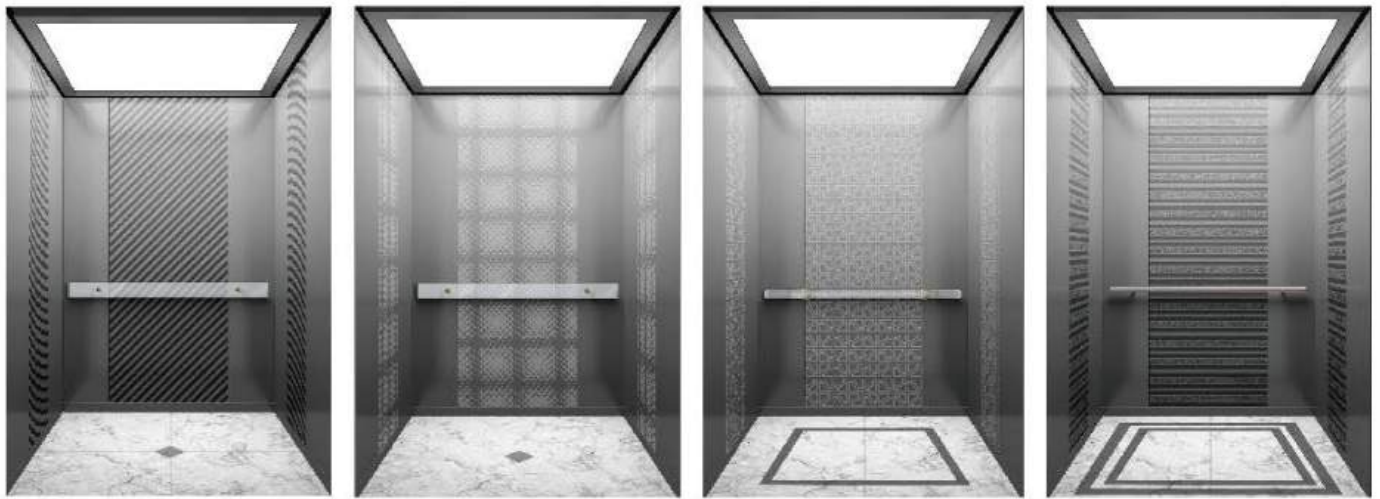

1 Intelligence system the genius in the city

Integral control system represents the developing orientation of the elevator control system. It is a new generation of intellectual vector type integral control system. It covers distance control, direct parking, closed-loop vector control technology, CANBUS communication technology, multi-CPU running technology and applies C and assembly language programming. It perfectly combines the contemporary industrial control technology, communication technology and traditional elevator. Compared with the traditional elevator control system, it brings about a high price and performance ratio and more convenient maintenance.



2 Permanent magnet synchronous gearless traction machine

We choose rare earth material and fully combine coaxial transmission technology and digital variable frequency technology with group computer combined control technology. With less running cost & less energy dissipated. Compared with the ordinary and traditional technology, Gearless traction machine can save more than 33% of the energy. Gearless traction machine needs no renewal of lubricant, No grease pollution, low noise, quiet & natural.



3 Top advanced door operator system

AUSTIN TESLA elevator applies the advanced VVVF variable voltage and variable frequency control technology to the elevator door operator system so as to ensure the smooth elevator door and quiet switch. What is more, the self-learning door load detector increases the sensitivity of the elevator door switching on/off. It monitors the variation of elevator door load on every floor. Automatically rectifying the most appropriate open shut speed in every floor so as to guarantee the security and reliability.



Environmental protection

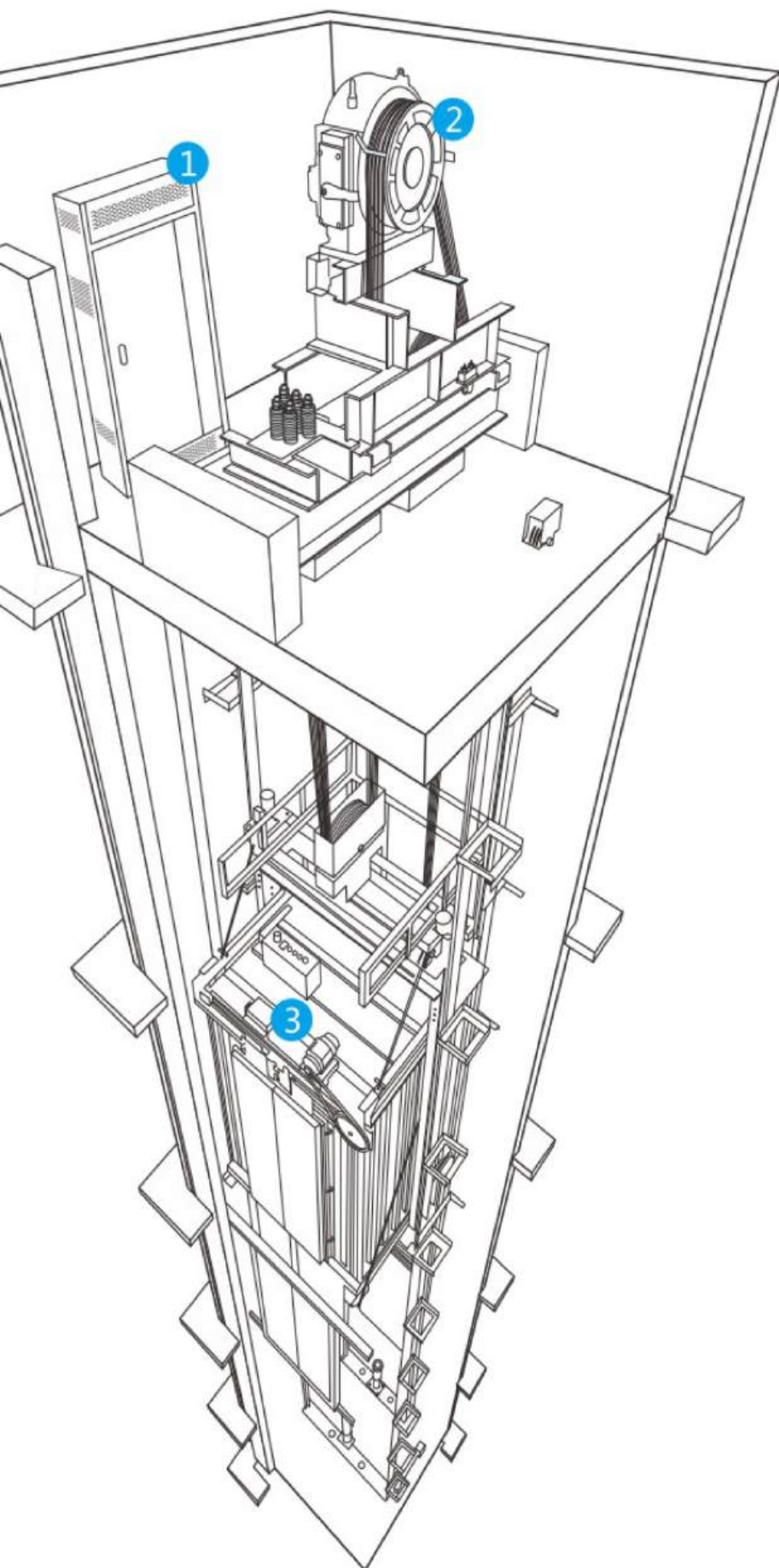



CONTACTS US

TESLA

TESLA ELEVATOR SYSTEM TECHNOLOGY

HQ Address : 5900 Balcones Drive SET 100

Austin , Texas, USA 78731

Factory Address: 1555 West Jinshajiang Road,
Jiading District, Shanghai, China

Phone: +1 521 333 2124

Email: info@tesla-elevator.com

Website: www.tesla-elevator.com